

RAWLPLUG®



EasyFix

Design solutions worth your while

Guidebook

Rawlplug EasyFix

Design solutions worth your while



What is it? 03

Who is it for? 06



What does it cover? 08

How to obtain the software? 16



Specific advantages to keep in mind 18

Download and use 21



EasyFix



Rawlplug EasyFix

What is it?

EasyFix

Rawlplug EasyFix is an innovative application

allowing you to conduct design calculations required to plan fixings for diverse construction elements using Rawlplug branded products.

Individual program modules are dedicated to specific segments of construction works. Each of them enables real-time calculations and provides the user with virtually unlimited possibilities of matching fixings and elements to be fixed to what is actually needed at the given time.

There is more to that, since subject-specific modules contain default elements chosen by taking into consideration individual needs related to diverse applications typical to construction investments.

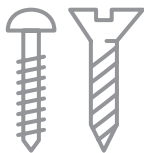

Fixing elements in concrete substrates

Fixing elements in masonry substrates

Fixing thermal and hydro-insulation materials to flat roofs

Fixing the ETICS system thermal insulation materials to facades

Chemical rebar anchoring in reinforced concrete

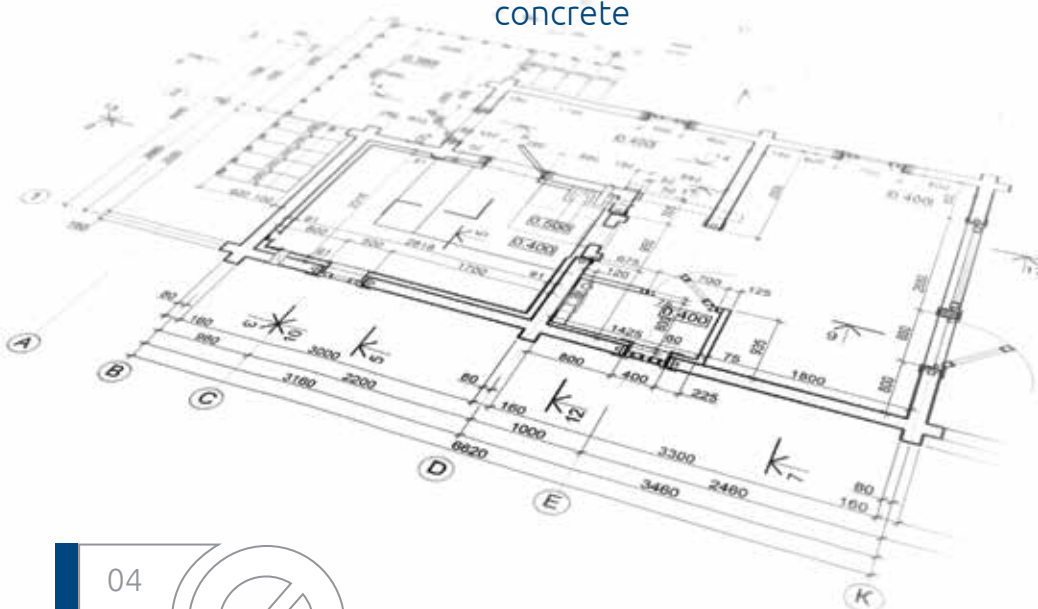

Rawlplug EasyFix is a signature tool

developed by a team of experts collaborating with professionals on a daily basis, watching them work and tracking their expectations. EasyFix springs from endless discussions on personal and business needs of our clients, about their experiences and the solutions they seek.

There is more to that, since Rawlplug EasyFix is kept up to date by following the latest design guidelines conforming with EAD, ETAG and EUROCODE, not only ensuring full compliance between calculations and standards, but also utmost precision and utility value.

What also matters is that the program is updated and improved on an ongoing basis by considering amendments to the applicable regulations, latest product tests run by Rawlplug as well as current market trends.

This is why EasyFix is a complementary response to real-life needs of architects, construction engineers and contractors.

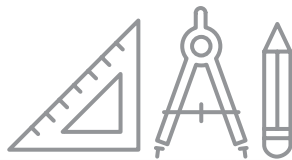

Proprietary tool

Conformity with EAD,
ETAG and Eurocode

Innovative solutions

Response to the needs
of professionals

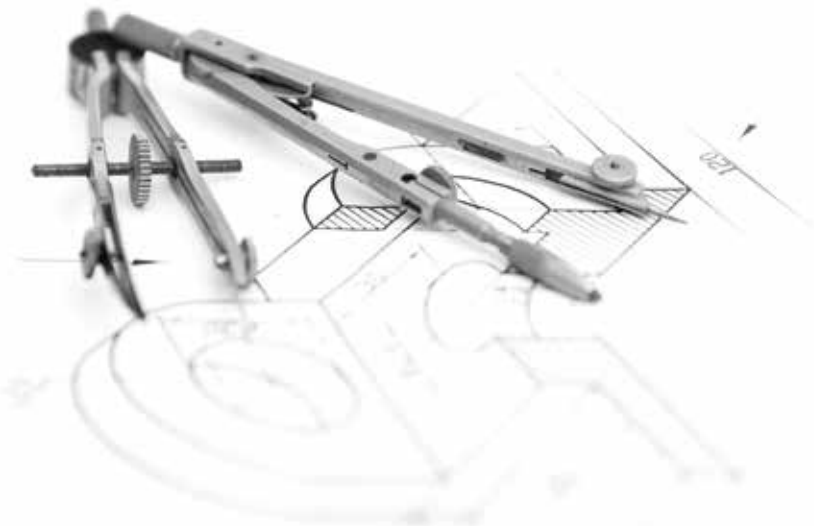



Rawlplug EasyFix

Who is it for?

EasyFix

Rawlplug EasyFix is intended for different groups of professionals:

CONSTRUCTION
ENGINEERS

ARCHITECTS

CONTRACTORS

What for?

It enables you to create building designs using reliable fixings, regardless of the investment type and scale.

Why?

Functionality and comfort are the two most straightforward words that summarise the advantages which the EasyFix application offers. It is good to know more about the key ones. Firstly, Individual EasyFix modules contain comprehensive information based on up-to-date guidelines intended for the given solution. Secondly, the program's interface is easy-to-use, transparent and very intuitive. Thirdly, what you receive is real-time display of results, meaning that on-screen results of the calculations you rely on are shown immediately after each modification of input data. Fourthly, the available set of both typical and highly specific filters allows you to find the optimum solution. Fifthly, the program's additional features enable optimisation of the elements to be fixed at an early stage of design work. And sixthly, the application enables you to pick items from an extensive database of BIM and CAD models and technical drawings rendered available by the BIM Rawlplug software, which makes both programs fully complementary.



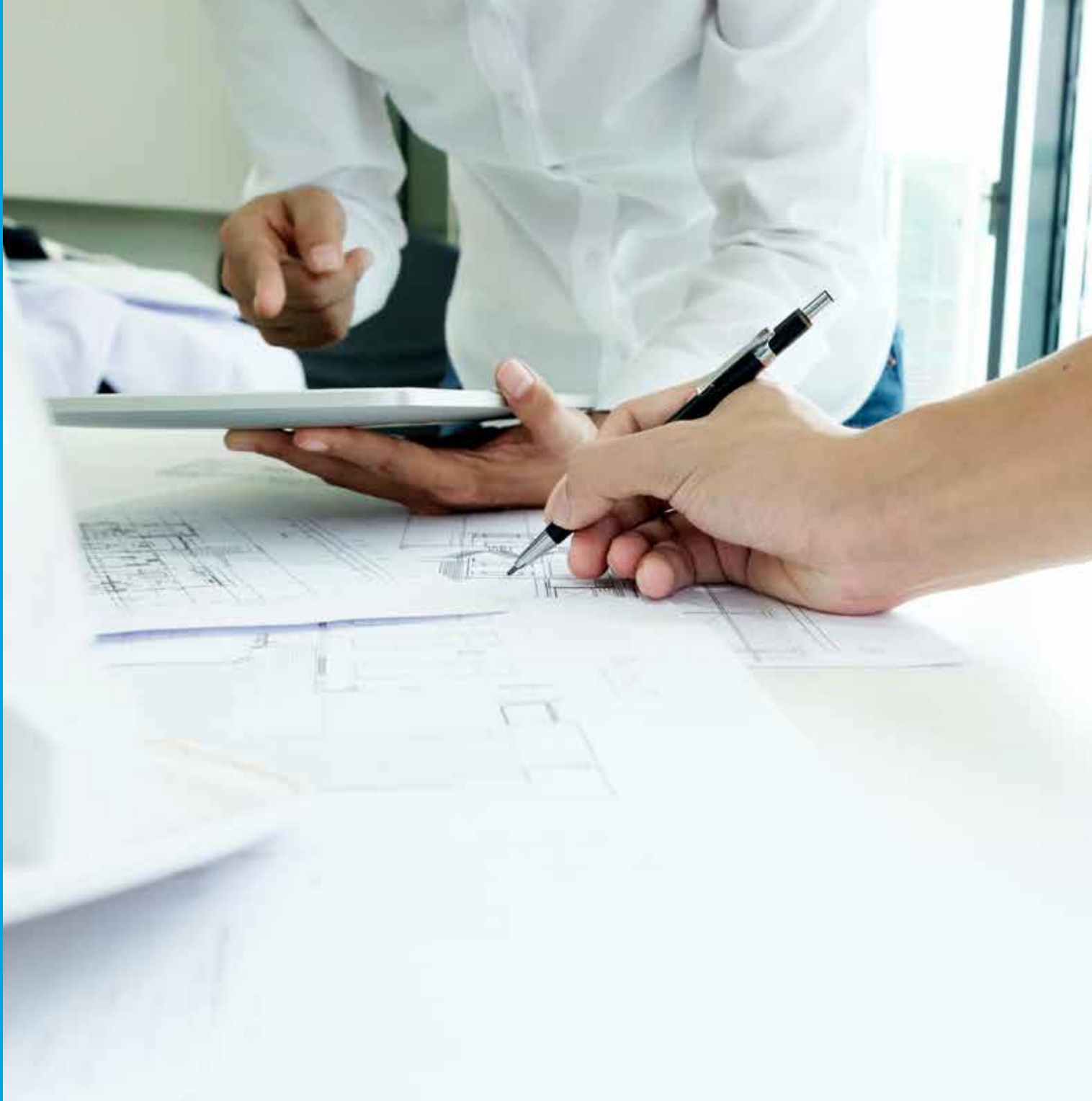

Rawlplug EasyFix

What does it cover?

EasyFix

The EasyFix application from Rawlplug covers 3 primary areas of operations:

1.

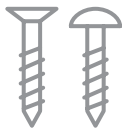

Designing of fixings for concrete substrates.

2.



Designing of chemical rebar anchoring in concrete substrates.

3.



Designing of fixings by taking wind forces into account.

Calculations pertaining to specific aspects are conducted using modules dedicated to individual segments of construction works. Each offers specific features that enable quick, precise and highly useful calculations which take the nature of the given scope of works into consideration.

SCOPE OF DESIGN ACTIVITY	MODULE TYPE	CONFORMITY BETWEEN MODULE FEATURES AND GUIDELINES
designing of fixings for concrete substrates	CONCRETE module	There are two calculation modules dedicated to this task, enabling computation to be performed in accordance with the guidelines provided in ETAG 001, Annex C, technical report EOTA TR 029, ETAG 020 for concrete substrates as well as the latest revision of the EN 992-4 standard for designing and EOTA TR 055.
	BALUSTRADE module	
designing of chemical rebar anchoring in concrete substrates	REBAR module	This category has a dedicated module that makes it possible to determine the required design depth of rebar anchoring in concrete structures based on the guidelines defined in the EN 1992-1-1 standard and Technical Report TR 023.
designing of fixings by taking wind forces into account	FLAT ROOF module	Two calculation modules are used for this purpose, delivering computational features based on the EN 1991-1-4 standard on wind actions as well as the Russian wind standard (СП 20.13330.2011). The relevant calculations also use data conforming with ETAG 006 and ETAG 014.
	FACADE module	





CONCRETE module

The available filters and optimisation functions provide you with an easy and quick solution to choose the appropriate type and size of fixings.

The module also makes it possible to calculate the required slab thickness.

Makes use of a wide range of possible arrangements of fixings on the element to be fixed.

Option to apply the proprietary REDM method (Rawlplug Engineering Design Method) based on many years of experience of Rawlplug's engineers as well as on European normative guidelines. This allows for designing of more complex anchor layouts.

Enter design loads and characteristic loads, including safety factors typical of the given region as well as seismic and fire conditions.

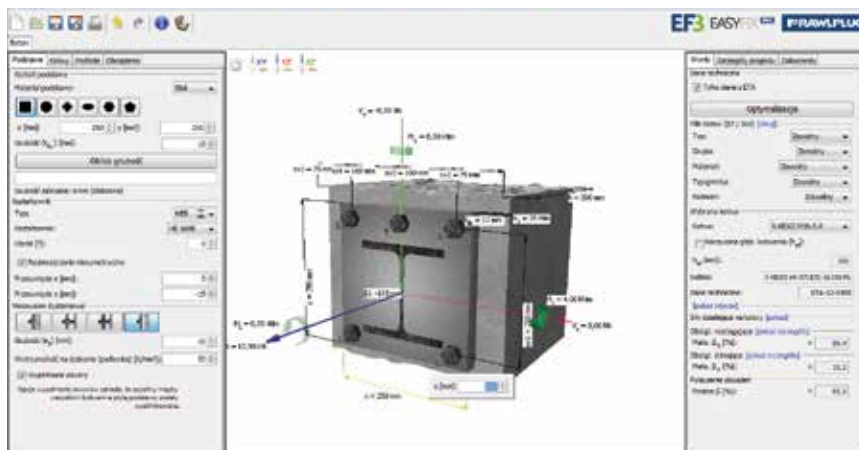

BALUSTRADE module



Design features that rely on guidelines defined for the BASE PLATE module.

Schematics matching the arrangements typically used when installing safety barriers.

Simplified model for entering load parameters.

Support for the guidelines of the EN 1991-1-1 standard on the response to loads.

Design fixings for concrete substrates.

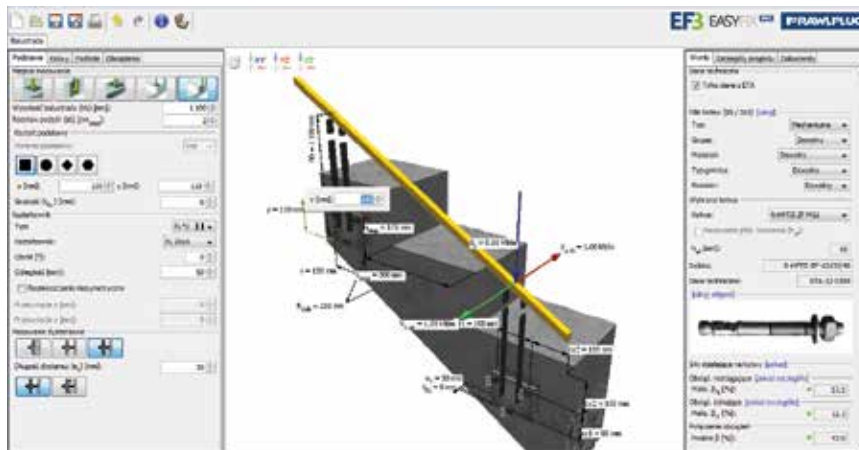

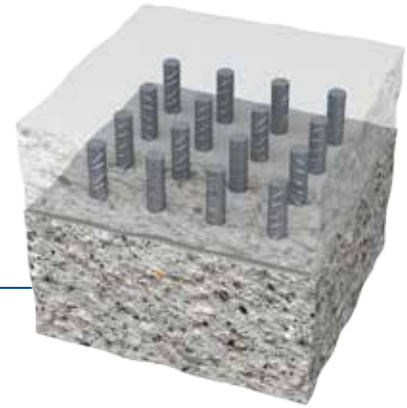

REBAR module

Make use of diverse combinations of elements of the existing and the new reinforcement available in default depending on the user's needs.

Define parameters of the existing reinforcement.

Calculate internal forces acting in cross-sections of the existing and the new rebars.

Apply the REDM method (Rawplug Engineering Design Method) based on many years of experience of Rawplug's engineers as well as on European normative guidelines. This allows for designing of more complex anchor layouts.

Define loads per a single bar or an entire cross-section, or calculate maximum forces transferred by joints taking mechanical strength of steel into consideration.

Apply a wide range of existing steel and concrete grades or user-defined data.

Design chemical rebar anchoring in concrete substrates.

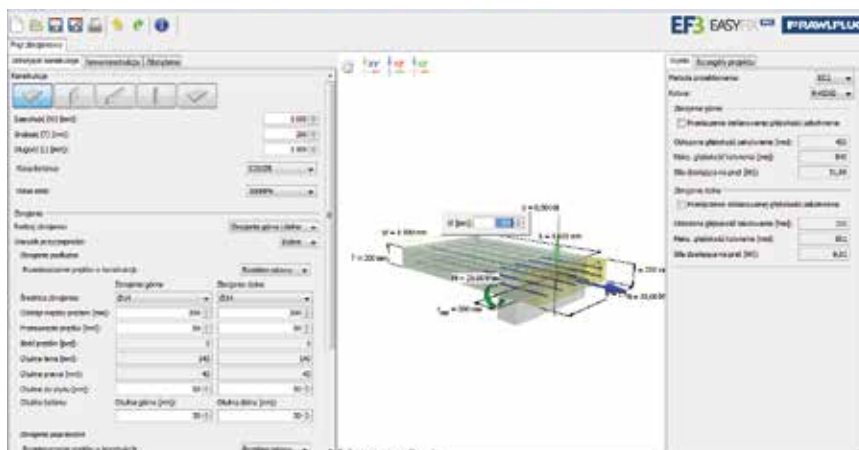

FLAT ROOF module

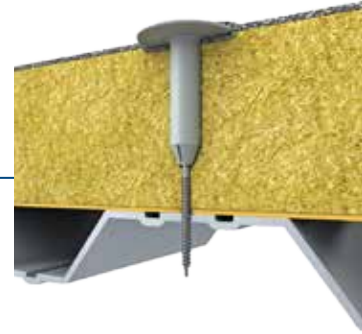

Design fixings for concrete, steel and wooden substrates.

Apply filters and optimisation functions for easy and quick selection of the appropriate type and size of fixings.

Make use of the possibility to define objects of any shape.

Take steel deck spacing into account for optimised fixing.

Design roof surface slopes and counterslopes with high accuracy, and define insulation thickness to enable optimised combination of length and type of fixings.

Run calculations based on wind action standards, tests of fixings conforming with ETAG 006 and wind tests of fixings with membranes from leading manufacturers.

Select suitable options from among available wind zones and land categories with reference to enclosed maps of many European countries.

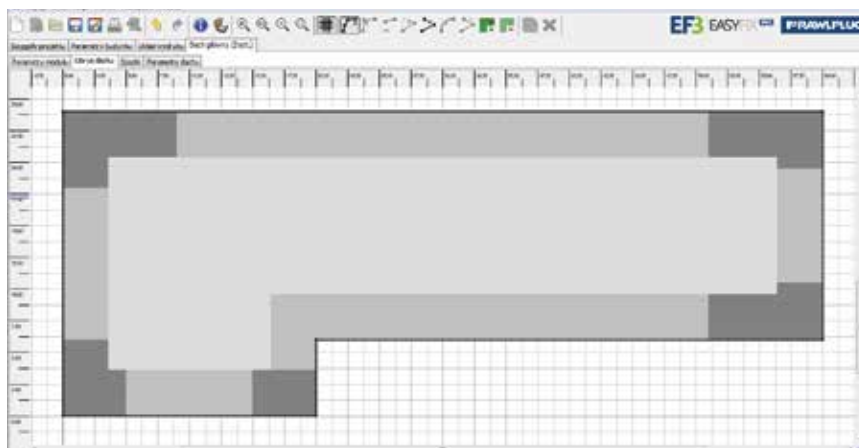

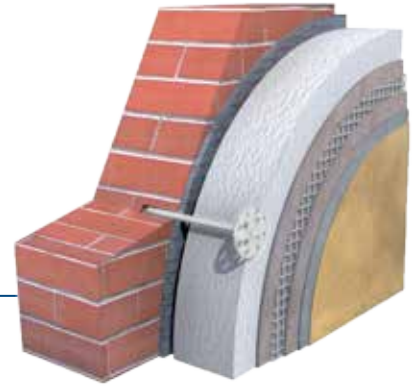

FACADE module

Design fixings for concrete, masonry, steel and wooden substrates.

Apply filters and optimisation functions for easy and quick selection of the appropriate type and size of fixings.

Benefit from a simplified model for building shape defining.

Make use of the option to exclude surface area of holes as well as entire selected walls from calculations.

Run calculations based on wind action standards, tests of fixings conforming with ETAG 014 and tests of fixings cooperating with the ETICS systems from leading manufacturers of lightweight wet insulation systems.

Select suitable options from among available wind zones and land categories with reference to enclosed maps.

Design fixings by taking wind forces into account.

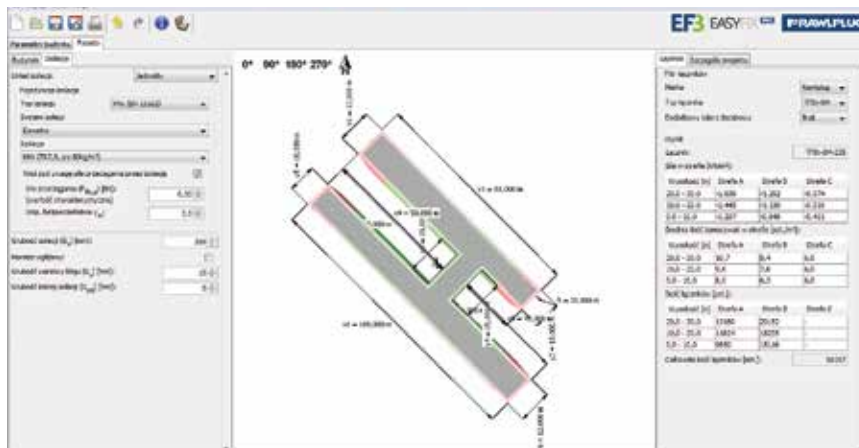

The Rawlplug EasyFix User Manual for individual modules is available:

A. on the rawlplug.com website

in the Services/Design & Software tab dedicated to the application,

B. directly in the program

for each module respectively. The User Manual provides a detailed summary of all features available under all tabs as well as very transparent presentation of these features using actual displays available in the application along with results of calculations shown on the screen.

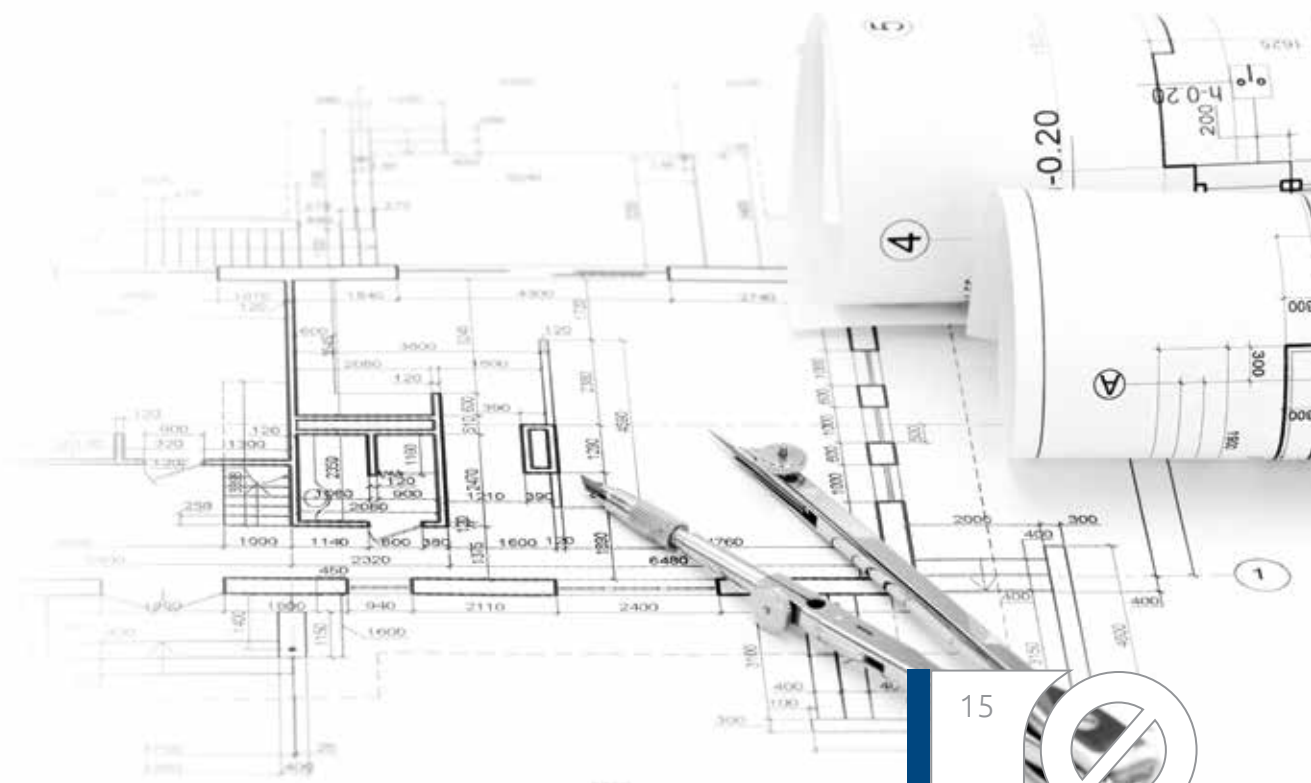



Rawlplug EasyFix

How to obtain the software?

EasyFix

You can obtain the software in two ways:

1. Install the EasyFix application



The EasyFix program from Rawlplug is a free-of-charge application dedicated and available to all those who design structures using professional fixings on a daily basis. In order to download the program, go to the rawlplug.com website and enter the Services/Design & Software tab, or make use of traditional data carriers that you can receive from Rawlplug's sales representatives. To use all the software features, you only need to register at rawlplug.com. Following the subscription, you will receive a clear activation instruction which allows for the unabridged version of EasyFix PRO to be installed.

2. Update your software



If you have already installed the program, it will automatically check for updates of modules and databases. The only requirements you must meet is to ensure Internet connection and accept terms and conditions of updating.

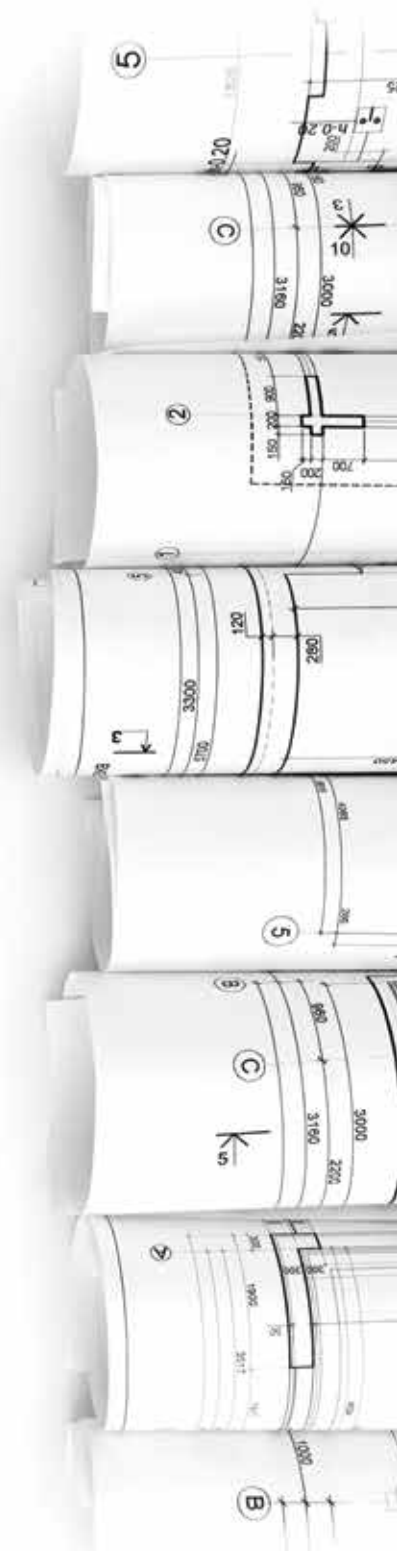

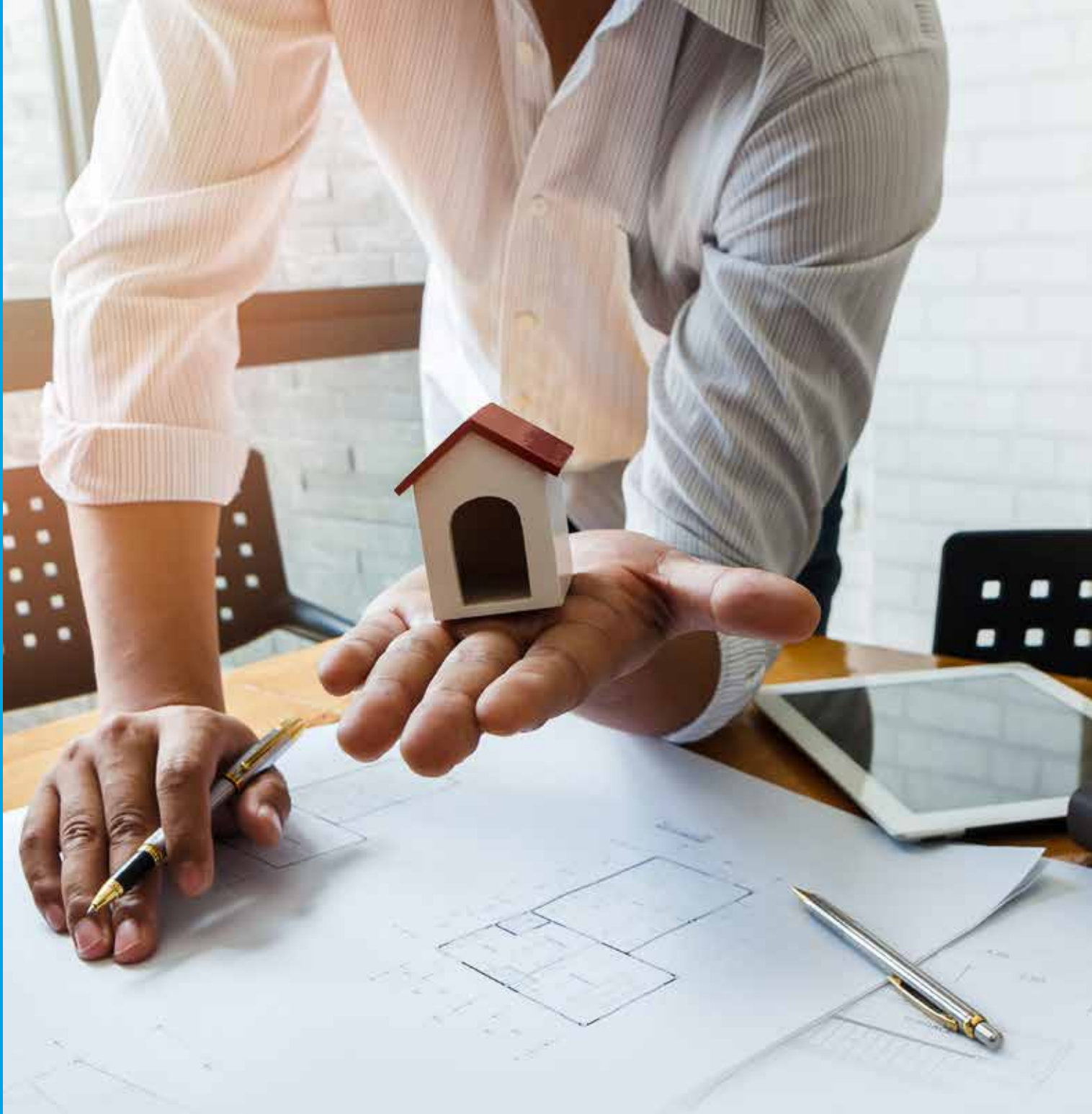

Rawlplug EasyFix

Specific advantages
to keep in mind

EasyFix

Rawlplug's EasyFix program offers specific advantages:

1. Make use of the intuitive and easy-to-use graphical interface
2. Enter input data quickly and easily
3. Calculation results ready to check immediately after each change of parameters
4. Direct print-out of results for the selected model
5. Download DWG drawings, approvals and technical datasheets for Rawlplug's products
6. Automatic online software update
7. Calculate parameters of bonded and mechanical anchors for concrete substrates
8. Choose from a wide selection of default shapes of elements to be fixed
9. Use the broad range of possible arrangements of fixings on the element to be fixed
10. Choose appropriate fixings for a wide range of masonry substrates
11. Optionally take wind loads into account depending on the object location
12. Select load parameters from a selection of available characteristic or design values
13. Check the percentage share of utilised load capacity of a whole group of fixings or individual load of individual fixings
14. Filter out results according to fixing group, material, diameter or type
15. Run calculations for specific applications



1. Reliable and novel

Rawlplug EasyFix incorporates advanced and innovative methods based on signature solutions for high-precision calculations with regard to practical real-life needs, applicable regulations, results of latest product tests as well as highly specialised knowledge and experience of Rawlplug's engineers.

2. Convenient and comprehensive

Rawlplug EasyFix allows you to use multiple variants and computational schemes ready to apply at different stages of design works, from foundations to the very roof top, and all of that combined in one package.

3. Useful and functional

Perform calculations by regarding even the most specific design needs, and make use of the wide array of features that correspond to real-life activities of professionals: architects, construction engineers and contractors.

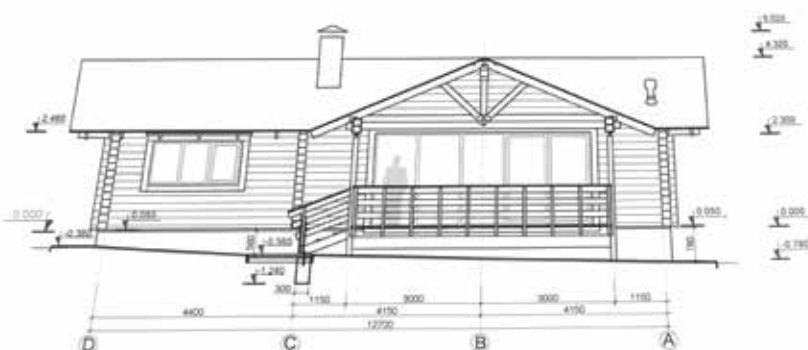



Rawlplug EasyFix

Download and use

EasyFix



Download the program
from www.rawlplug.com

rawlplug.com/en/services/design-software-applications/easyfix-calculation-software

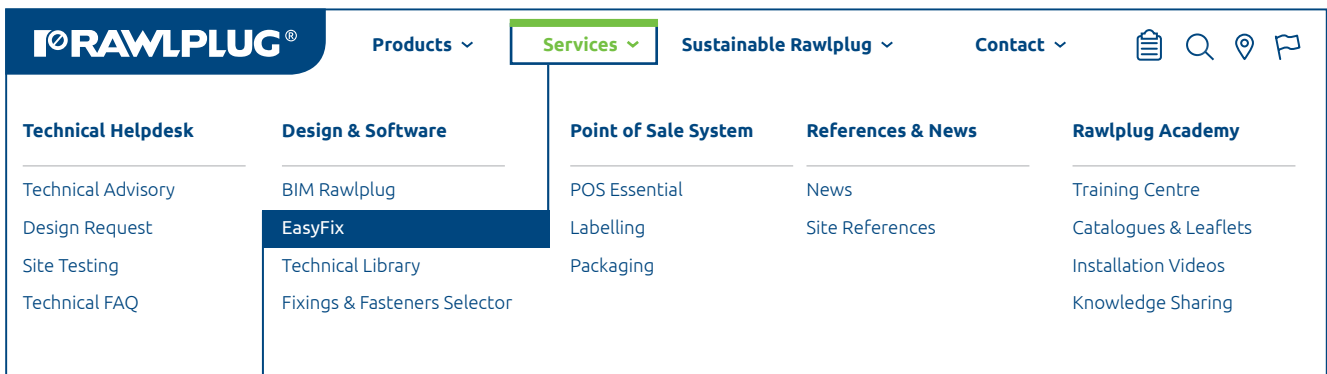

The screenshot shows the website's navigation bar with the Rawlplug logo on the left. The main navigation menu includes: Products, Services (highlighted), Sustainable Rawlplug, and Contact. Below the Services menu, there are five columns of sub-links: Technical Helpdesk, Design & Software, Point of Sale System, References & News, and Rawlplug Academy. The 'EasyFix' link under 'Design & Software' is highlighted.

Technical Helpdesk	Design & Software	Point of Sale System	References & News	Rawlplug Academy
Technical Advisory	BIM Rawlplug	POS Essential	News	Training Centre
Design Request	EasyFix	Labelling	Site References	Catalogues & Leaflets
Site Testing	Technical Library	Packaging		Installation Videos
Technical FAQ	Fixings & Fasteners Selector			Knowledge Sharing





Tabs available in individual EasyFix modules:

CONCRETE module	BALUSTRADE module	REBAR module	FACADE module	FLAT ROOF module
<ul style="list-style-type: none"> 1. Fixture 2. Anchors 3. Substrate 4. Loads 5. Results 6. Project details 7. Documents 	<ul style="list-style-type: none"> 1. Fixture 2. Anchors 3. Substrate 4. Loads 5. Results 6. Project details 7. Documents 	<ul style="list-style-type: none"> 1. Existing construction 2. New construction 3. Loads 4. Results 	<ul style="list-style-type: none"> 1. Location 2. Building 3. Insulation 4. Fixings 5. Project properties 	<ul style="list-style-type: none"> 1. Project details 2. Location 3. Building parameters 4. Roofoutline 5. Slopes 6. Roof parameters

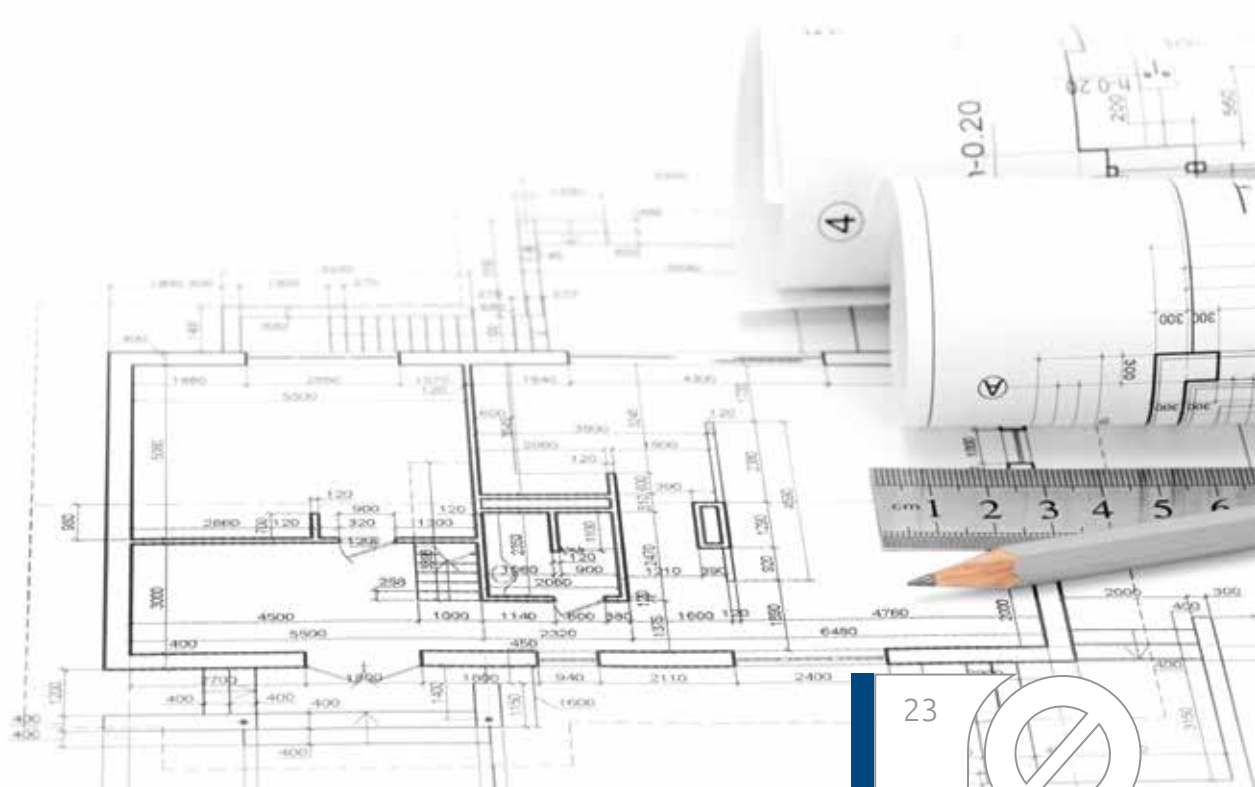

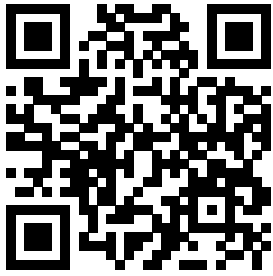

www.rawlplug.com